

Congratulations on your purchase of the Fender® Passport® Event audio system. Your Passport is a self-contained, Portable audio system that includes everything you need for great sound anywhere you go! Carry your Passport as you would a suitcase. When you arrive, simply flip open the cabinet release latches and inside you'll discover two full-range speaker cabinets, a powered mixer, a microphone, plus all the cables you'll need to get started.

Use your Passport as a public address system or to amplify musical instruments and singing. You can connect a music playback device such as an MP3 player, CD player or laptop to provide accompaniment. The Passport's quick and easy set-up, its ability to cover large audiences and its simple operation

are the hallmarks of this innovative product. The Passport's control panel features both mono mic/line channels and stereo line channels with a variety of input jacks to provide you with superb flexibility in making connections.

Don't forget to visit [www.fender.com/passport](http://www.fender.com/passport) to see a full line of Passport accessories and more!

Please visit the individual product page at: [www.fender.com/series/passport](http://www.fender.com/series/passport) for full warranty details and instructions on how to get your system serviced under warranty in U.S.A. and Canada; see your Fender distributor for warranty details in other countries.

**PRODUCT REGISTRATION** — Please visit: [www.fender.com/product-registration](http://www.fender.com/product-registration)

## System Set-Up

1. Flip open the cabinet latches on top of the Passport and detach the speaker cabinets from the powered mixer section.

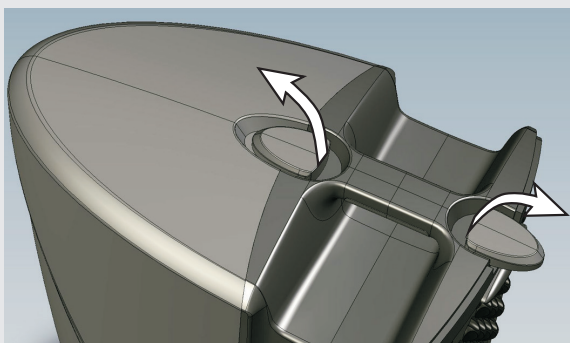

2. For optimal results, elevate the speaker cabinets on Passport Speaker Stands or on sturdy tables and place the speakers far apart to maximize stereo separation. Position the mixer close to where you will be performing so you will have easy access to the control panel.



3. Open the storage compartment on the rear of the mixer and remove the power cord, microphone and speaker cables.

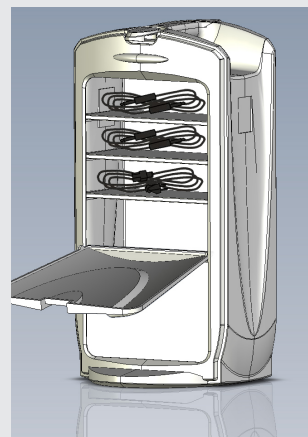

4. Plug the speaker cables into the left and right speaker jacks on the back of the mixer, then connect the corresponding left and right speakers. Make sure the power switch is off, then plug the supplied power cord into the power socket on the back of the mixer and the other end into a grounded AC power outlet.

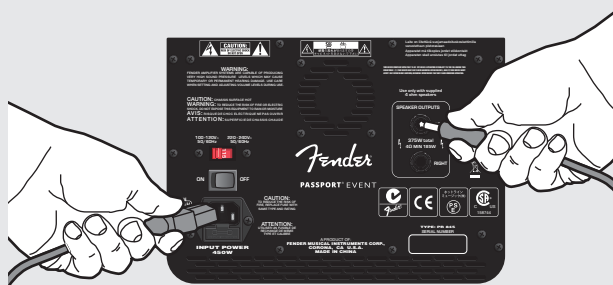

5. Connect each of your microphones, instruments and other sound sources into separate channels using the appropriate type of input jack. Use the mono channels on the left for monophonic sources such as microphones and use the stereo channels on the right for stereo/mono sources such as CD players, MP3 players, keyboards and other line level audio devices.



6. Rotate the MASTER VOLUME knob, all channel VOLUME knobs and all REVERB knobs fully counter-clockwise to start.



7. Turn on all equipment connected to the Passport first, then switch the Passport on. The Power LED on the Passport should illuminate green (Protect LED will illuminate briefly).

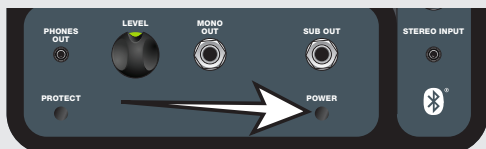

8. Turn the MASTER VOLUME knob up to 1/4 volume.

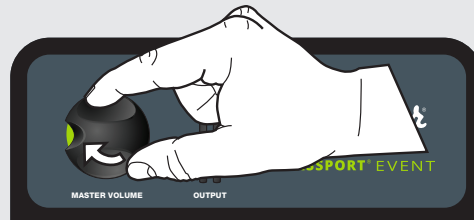

9. Connect a microphone (or other source) and use it at the intended level, while slowly turning up that Channel's VOLUME knob. Watch the signal LED above the VOLUME knob. The LED illuminates green when small signals are present, changes to yellow when the signal is strong, and turns RED when clipping (distortion) occurs from too strong of signals. For best performance, set the VOLUME and TONE controls so that the LED is yellow or green. If the LED is turning red, reduce the VOLUME or TONE knob settings. If the LED is still turning red after adjusting VOLUME/TONE, press the PAD button in.



10. Set up each of the other channels in the same way. Use the channel VOLUME knobs to adjust the relative loudness of each channel until you get the right over-all balance, then use the MASTER VOLUME knob to adjust everything together. The MASTER VOLUME knob on your Passport has signal level meters. If you see the meters illuminate into the RED zone, turn down the MASTER VOLUME knob.



11. Start with each of the tone knobs (TREBLE, BASS) in the center detent position. At this setting they have no equalization effect. From there you can experiment by turning each tone control to see what sounds best to you. If possible, have someone walk to each corner of the room and make sure the settings and speaker positions provide clear and consistent coverage throughout your audience.

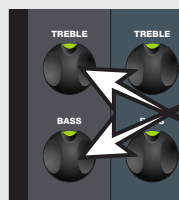

Basic set-up is now complete! The following pages contain detailed information on each of the Passport Event's many features.

## Master Controls



- Ⓐ **MASTER VOLUME** — Use to adjust the overall loudness of your Passport. When this knob is rotated fully counter-clockwise, there will be no sound coming out of the Passport speakers.
- Ⓑ **LEVEL METERS** — Indicates left/right power amp signal levels. If the level meters illuminate into the RED zone, reduce the MASTER VOLUME level to prevent sound distortion and to avoid amplifier overload and shutdown (see Power/Protect LED Ⓡ to reset the unit after a protect mode shutdown).

## Channel Controls

- Ⓒ **SIGNAL PRESENT / CLIP INDICATOR** — This LED illuminates green to indicate an input signal level is present in the channel. It turns yellow when the input signal level gets closer to clipping (-10dB from clip) and red during clipping (distorting). For best performance, set the VOLUME and TONE controls so that the LED is yellow or green. If the LED is turning red, reduce the VOLUME or TONE knob settings. If the LED is still turning red after adjusting VOLUME/TONE, press the PAD button in.
- Ⓓ **VOLUME** — Use to adjust each channel's volume relative to the loudness of the other channels.
- Ⓔ **TREBLE / BASS** — Use to adjust the tone character of each channel. In the center detent position the tone control is "flat" and has no effect on the channel's sound.
- Ⓕ **REVERB** — Adjusts the level of the Reverb effect in each channel.
- Ⓖ **PAD** — Press in to reduce the input sensitivity of the channel by 20dB if the source level is too high (see Ⓒ above).



## Channel 1–4 Inputs

- Ⓗ **XLR** — Connect microphones or line level sources here. Use of the PAD button is recommended for line level (powered) signals.



## Line/Instrument Channel 5

- Ⓐ **LINE / INSTRUMENT** — For passive instruments (such as electric guitars and basses) press the LINE/INSTR. switch in (on) to activate the high-impedance (Hi-Z) instrument pre-amplifier. If clipping (distortion) occurs and/or for line-level inputs, leave the LINE/INSTR. switch in the out (off) position.



- Ⓙ **1/4"** — Connect Instrument or line-level signals here.

## Stereo Channel 6/7

- Ⓚ **PAIR BLUETOOTH®** — Press the PAIR button to activate the Bluetooth module and pair it with an external device. When the PAIR button's blue light is flashing, select "Passport Event" in the external device's Bluetooth menu. The PAIR button's blue light will stop blinking and stay on steady when the Bluetooth connection is ready to use.



Press and hold the PAIR button to disconnect the Bluetooth device. For best sound quality, set the volume control on the external device (i.e. smart phone) to 75-100% of its maximum level.

- Ⓛ **1/4" LEFT (MONO) / RIGHT** — Plug a line-level stereo source that requires separate 1/4" connections for each channel, into these jacks. You can also use a stereo channel as a mono channel by using only the L/MONO jack (mono output will be through both speakers).
- Ⓜ **1/8" STEREO** — Plug your MP3 player, computer, or other line-level, stereo source into this jack.

## Front Panel Outputs

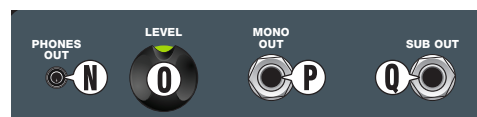

- Ⓝ **STEREO / PHONES OUT** — Connect recording equipment or headphones here. MASTER VOLUME does not effect this output, but each of the channel controls do.
- Ⓞ **LEVEL** — Adjusts the output level of the PHONES OUT and MONO OUT jacks to accommodate the input level requirements of your external equipment.
- Ⓟ **MONO OUT** — Use this output to connect to a powered monitor. The signal level is pre-MASTER volume control, but can be adjusted with the LEVEL control Ⓞ.

- ① **SUB OUT** — Output connection for a powered subwoofer such as the Fender® PS-512. Set the external subwoofer's "Crossover Frequency" control to 120Hz. The subwoofer's "Volume" or "Level" control can be adjusted to give the desired amount of bass.

 *Bass signals require more power than any other signals, and will quickly max out the Passport System. Connecting a subwoofer to this jack automatically removes the bass signals (below 120Hz) from the main Passport amp and speakers, allowing it to focus on everything except for bass, while the external Subwoofer handles the bass. This will result in a louder and better sounding system.*

### Power/Protect LEDs



- Ⓡ **POWER / PROTECT** — The Power LED will illuminate green when the Passport is turned on. If the Protect LED illuminates red, the Passport amplifier has shutdown to protect itself from electrical or thermal trouble. The Passport will reset itself as soon as the problem has been resolved. If the Passport will not reset and the Protect light stays red even after you've tried different power outlets and given it time to cool down, take it to an authorized Fender Service Center. If neither LED illuminates when powered on, check the Fuse ⓓ in the Power Socket.

### Rear Panel

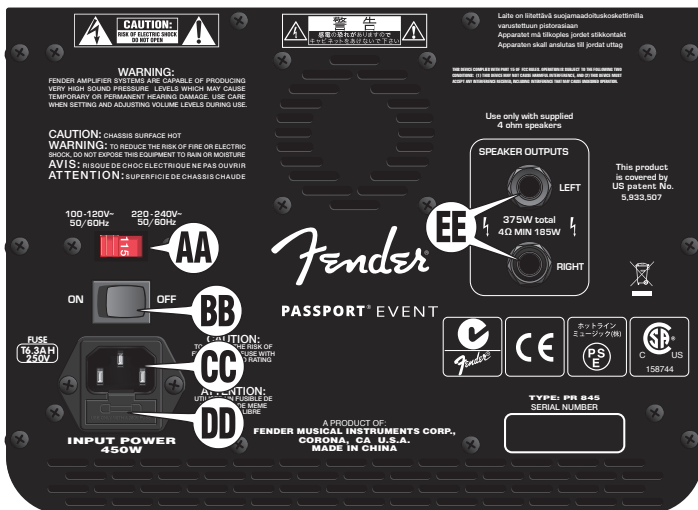

- Ⓐ **VOLTAGE SELECTOR** — Change this setting only if you travel to a country that requires a different voltage setting.
- Ⓑ **POWER** — Switches the Passport on-off.
- Ⓒ **POWER SOCKET** — Connect to a grounded AC outlet in accordance with the proper VOLTAGE SELECTOR Ⓐ setting.

- ⓓ **FUSE** — To replace a failed fuse, unplug the power cord, then pry the fuse holder out of the POWER SOCKET Ⓒ. Only use a fuse of the same type and rating.
- ⓔ **SPEAKER OUTPUTS** — Connect the Passport speakers here using the cables provided.

### Specifications

<b>TYPE:</b>	PR 845
<b>PART NUMBERS:</b>	6946000000 (120V~, 60Hz) 6946000900 (120V~, 60Hz) DS 6946001900 (110V~, 60Hz) TW DS 6946003900 (240V~, 50Hz) AU DS 6946004900 (230V~, 50Hz) UK DS 6946005900 (220V~, 50Hz) ARG DS 6946006900 (230V~, 50Hz) EU DS 6946007900 (100V~, 50/60Hz) JP DS 6946008900 (220V~, 50/60Hz) CN DS 6946009900 (220V~, 60Hz) ROK DS 6946013900 (240V~, 50Hz) MA DS
<b>POWER REQUIREMENT:</b>	450W
<b>FUSE:</b>	T6.3A H, 250V
<b>DIMENSIONS:</b>	Height: 23 in (58.42 cm) Width: 29 in (73.66 cm) Depth: 11 in (27.94 cm)
<b>WEIGHT:</b>	44 lb (19.96 kg)



*Product specifications are subject to change without notice.*